

Specifications

- Block Body, Medium Duty
- 50,000 Cycle Seal Life
- NPT, BSP and SAE Ports Available
- 1/4" - 1 1/2" Sizes Available
- Fully Ported
- Carbon Steel Body
- Chrome Plated Brass Ball
- Temperature Range: -14°F to 212°F (-10°C to 100°C) (depending on material combinations)

Options

- Locking Kits
- Limit Switches
- Straight Handles

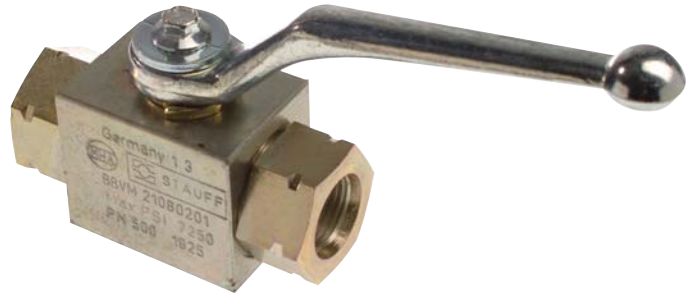

Dimensional Information

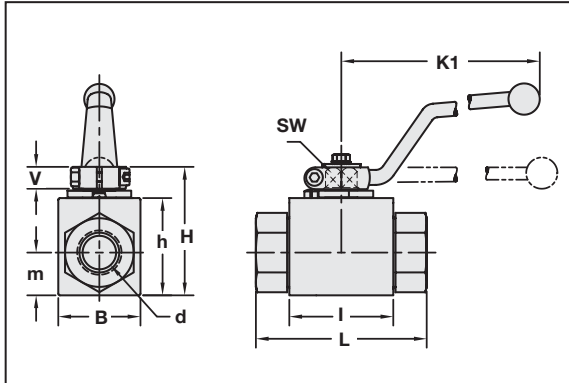

See Page V4 for Pressure Rating

Part #	Size	d NPT	d SAE	L NPT	L SAE	l	B	H	h	m	V	SW	K ₁	Weight		Max. Working Pressure	
														lb	kg	PSI	Bar
BBVM 20040201 BBVM 21040201	1/4"	1/8-18	7/16-20	2.72 69.09	2.72 69.09	1.57 39.88	1.02 25.91	1.85 46.99	1.30 33.02	0.53 13.46	0.43 10.92	0.35 9	4.53 115.06	0.66 0.30	7250 500		
BBVM 20060201 BBVM 21060201	3/8"	1/8-18	3/8-18	3.07 77.98	2.83 71.88	1.69 42.93	1.26 32.00	2.05 52.07	1.50 38.10	0.69 17.53	0.43 10.92	0.35 9	4.53 115.06	1.10 0.50	7250 500		
BBVM 20080201 BBVM 21080201	1/2"	1/4-14	3/8-16	4.09 103.89	3.27 83.06	1.89 48.01	1.38 35.05	2.13 54.10	1.57 39.88	0.75 19.05	0.55 14	0.35 9	4.53 115.06	1.65 0.75	7250 500		
BBVM 20120201 BBVM 21120201	3/4"	3/8-14	1/2-12	4.02 102.11	3.74 95.00	2.44 61.98	1.93 49.02	2.95 74.93	2.24 56.90	0.90 22.86	0.55 14	0.55 14	6.81 172.97	3.65 1.66	5000 345		
BBVM 20160201 BBVM 21160201	1"	1-11 1/2	1 1/8-12	4.69 119.13	4.45 113.03	2.60 66.04	2.28 57.91	3.27 83	2.56 65	1.16 29.46	0.55 14	0.55 14	7.87 199.90	5.06 2.30	5000 345		
BBVM 20200201 BBVM 21200201	1 1/4"	1 1/4-11 1/2	1 1/8-12	5.10 130	5.10 130	2.60 66	2.28 58	3.27 83	2.56 65	1.16 29.5	0.55 14	0.55 14	7.87 200	5.5 2.5	3600 250		
BBVM 20240201 BBVM 21240201	1 1/2"	1 1/4-11 1/2	1 1/8-12	5.2 82	5.2 132	2.60 66	2.28 58	3.27 83	2.56 65	1.16 29.5	0.55 14	0.55 14	7.87 200	5.75 2.6	3600 250		

Ordering Information

BBVM 2 0 08 0 2 0 1 - LD

Product Type Block Body Valve-Medium Pressure	Connector Size 04 - 1/4" 06 - 3/8" 08 - 1/2" 12 - 3/4" 16 - 1" * 20 - 1 1/4 * 24 - 1 1/2 * Reduced Bore(1")	Locking Kit LD - Locking Device OMIT - No Locking Device
Number of Ports		O Ring Material 1 - Viton
Thread Type 0 - NPT 1 - SAE R - BSP		Seat Material 0 - Delrin
Body Material 0 - Carbon Steel Zinc Plated		Ball Material 2 - Brass-Chrome Plated

* Reduced Bore