



Two-Way Valves - FBV Series

Specifications

- Forged Body, High Pressure Valves
- 1¼" – 2" Fully Ported
- NPT, BSP or SAE O-Ring Connections
- Delrin +MoS2 Ball Seats
- Viton O-Rings
- Steel Handle
- Pressure Range: Up to 5000 PSI (345 bar)
- Carbon Steel Construction
- Temperature Range: -20°F to 212°F (-28°C to 100°C)
- Zinc Plated Body

Options

- Locking Kits
- Limit Switches
- Stainless Steel Body
- Stainless Steel Ball and Stem
- Straight Handles
- Actuator Packages Available
- Special seat and "O"-Ring materials available for higher temperatures or more aggressive media.



Technical Information

Item Number	Quantity	Description
1	1	Housing
2	1	Ball
3*	2	Seat
4*	2	Connector O-Ring
5	2	Connector
6	1	Stop Pin
7	1	Stem
8*	1	Thrust Ring
9*	1	Stem O-Ring
10	1	Cam Plate
11	1	Snap Ring
12	1	Steel Handle
13	1	Screw
14	1	Lock Washer
15	1	Washer

*Included in Seal Kit

Size		Part Number	Maximum Working Pressure	
			PSI	Bar
1¼"	NPT	FBV20200001M	5000 PSI	345
	SAE	FBV21200001M	5000 PSI	345
1½"	NPT	FBV20240001M	5000 PSI	345
	SAE	FBV21240001M	5000 PSI	345
2"	NPT	FBV20320001M	5000 PSI	345
	SAE	FBV21320001M	5000 PSI	345

Dimensional Information

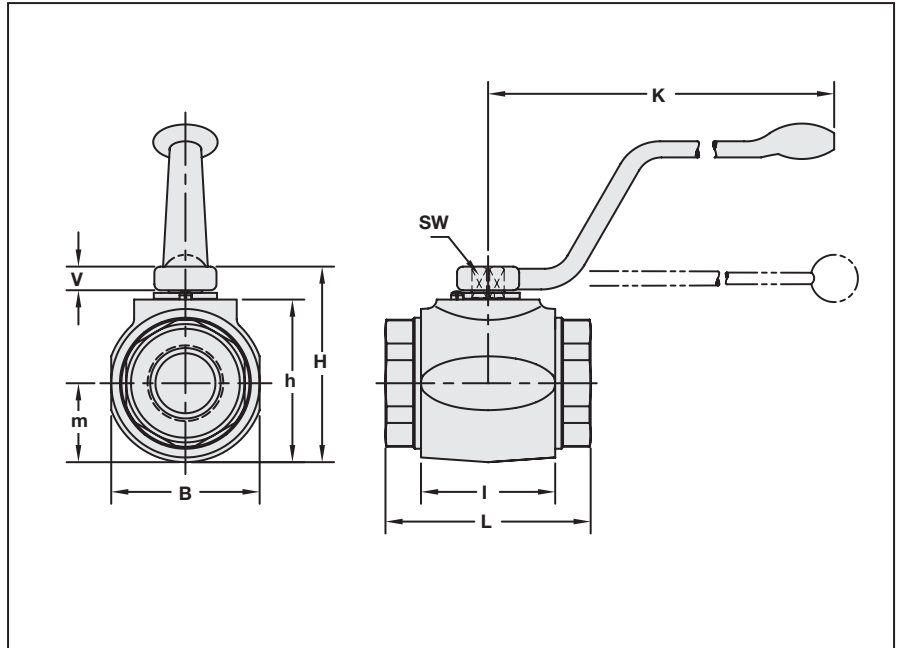
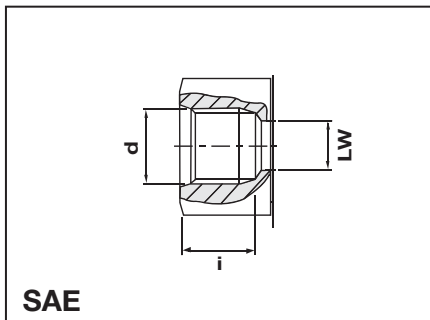
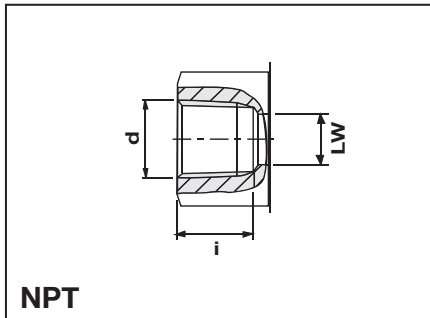

Size	d	d	i	i	L	L	LW	LW	I	B	H	h	m	V	SW	K	Weight
	NPT	SAE	NPT	SAE	NPT	SAE	NPT	SAE	in	in	in	in	in	in	in	in	lbs
			in	in	in	in	in	in	in	in	in	in	in	in	in	in	kg
1¼"	1¼-1½	1½-12	1.11 28.19	0.91 23.11	4.72 119.89	4.37 111.00	1.26 32.00	1.18 29.97	3.15 80.01	3.19 81.03	4.21 106.93	3.39 86.11	1.59 40.39	0.65 16.51	.66 17	11.81 300	8.04 3.65
1½"	1½-11½	1½-12	1.1 27.94	0.91 23.11	5.12 130.05	5.12 130.05	1.50 38.10	1.50 38.10	3.35 85.09	3.94 100.08	4.88 123.95	4.06 103.12	1.97 50.04	0.65 16.51	.66 17	11.81 300	13.00 5.91
2"	2-11½	2½-12	1.19 30.23	0.91 23.11	5.51 139.95	5.51 139.95	1.89 48.01	1.77 44.96	3.94 100.08	4.65 118.11	5.43 137.92	4.61 117.09	2.32 58.93	0.65 16.51	.66 17	11.81 300	19.00 8.64

Ordering Information

