



Two-Way Valves FBV 22/23 Series - SAE Split Flange

Specifications

- 1¼", 1½" & 2" Forged Body Style
- Pressure Range: Up to 6000 PSI (400 bar)
- SAE Code 61 & 62 (SAE Standard J518)
- Split Flange Connectors
- Delrin +MoS2 Ball Seats
- Viton O-Rings
- Carbon Steel Construction
- Steel Handle
- Temperature Range: -20°F to 212°F (-28°C to 100°C)
- Zinc Plated Body

Options

- Split Flange Kits Available
SF Series for Both Code 61 & Code 62
(see page A39)
- Straight Handle
- Locking Kits
- Limit Switches
- Actuator Packages Available
- Stainless Steel
- Special Seat and "O"-Ring Materials
Available for Higher Temperatures or More
Aggressive Media



Technical Information

Item Number	Quantity	Description
1	1	Housing
2	1	Ball
3*	2	Seat
4*	2	Connector O-Ring
5	2	Connector
6	1	Stop Pin
7	1	Stem
8*	1	Thrust Ring
9*	1	Stem O-Ring
10	1	Cam Plate
11	1	Snap Ring
12	1	Steel Handle
13	1	Screw
14	1	Lock Washer
15	1	Washer

*Included in Seal Kit

VALVES

Size	Part Number Without Flanges	Part Number With Flanges	Maximum Working Pressure	
			PSI	Bar
1¼"	CODE 61	FBV22200001M	3000 PSI	210
	CODE 62	FBV23200001M	6000 PSI	420
1½"	CODE 61	FBV22240001M	3000 PSI	210
	CODE 62	FBV23240001M	6000 PSI	420
2"	CODE 61	FBV22320001M	3000 PSI	210
	CODE 62	FBV23320001M	6000 PSI	420

Dimensional Information

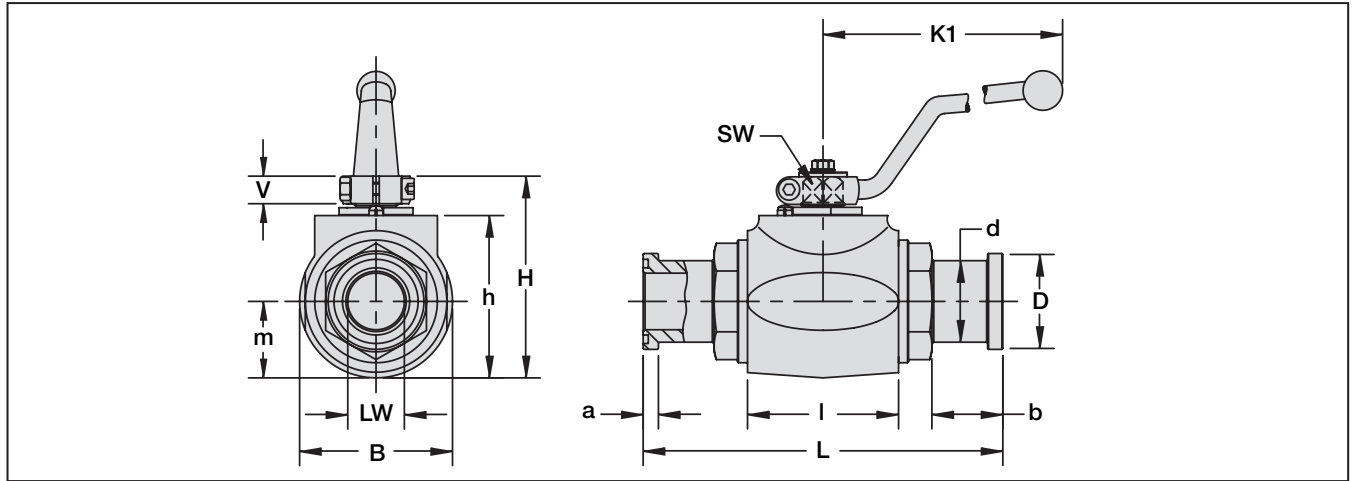

Code 61

Size	LW	L	I	B	H	h	m	V	SW	K1	D	d	a	b	Weight	
	in / mm	in / mm	in / mm	in / mm	in / mm	in / mm	in / mm	in / mm	in / mm	in / mm	in / mm	in / mm	in / mm	in / mm	lbs	kg
1 1/4"	1.18 / 29.97	7.50 / 190.50	3.15 / 80.01	3.19 / 81.03	4.21 / 106.93	3.39 / 86.11	1.59 / 40.39	0.65 / 16.51	0.67 / 17	11.81 / 299.97	2.00 / 50.80	1.70 / 43.18	0.32 / 8.13	1.38 / 35.05	8	3.64
1 1/2"	1.42 / 36.07	9.09 / 230.89	3.35 / 85.09	3.94 / 100.08	4.88 / 123.95	4.06 / 103.12	1.97 / 50.04	0.65 / 16.51	0.67 / 17	11.81 / 299.97	2.37 / 60.20	1.98 / 50.29	0.32 / 8.13	2.09 / 53.09	14	6.36
2"	1.89 / 48.01	9.13 / 231.90	3.94 / 100.08	4.65 / 118.11	5.43 / 137.92	4.61 / 117.09	2.32 / 58.93	0.65 / 16.51	0.67 / 17	11.81 / 299.97	2.81 / 71.37	2.45 / 62.23	0.38 / 8.13	1.81 / 45.97	20	9.09

Code 62

Size	LW	L	I	B	H	h	m	V	SW	K1	D	d	a	b	Weight	
	in / mm	in / mm	in / mm	in / mm	in / mm	in / mm	in / mm	in / mm	in / mm	in / mm	in / mm	in / mm	in / mm	in / mm	lbs	kg
1 1/4"	1.06 / 26.92	8.78 / 223.01	3.15 / 80.01	3.19 / 81.03	4.21 / 106.93	3.39 / 86.11	1.59 / 40.39	0.65 / 16.51	0.67 / 17	11.81 / 299.97	2.13 / 54.10	1.73 / 43.94	0.41 / 10.41	2.01 / 51.05	8.5	3.86
1 1/2"	1.26 / 32.00	11.06 / 280.92	3.35 / 85.09	3.94 / 100.08	4.88 / 123.95	4.06 / 103.12	1.97 / 50.04	0.65 / 16.51	0.67 / 17	11.81 / 299.97	2.50 / 63.50	2.01 / 51.05	0.50 / 12.70	3.07 / 77.98	15	6.82
2"	1.77 / 44.96	12.44 / 315.98	3.94 / 100.08	4.65 / 118.11	5.43 / 137.92	4.61 / 117.09	2.32 / 58.93	0.65 / 16.51	0.67 / 17	11.81 / 299.97	3.13 / 79.50	2.65 / 67.31	0.50 / 12.70	3.46 / 87.88	21	9.55

Ordering Information

